

# HC-2250

## Desiccant Dehumidifier



### Product Description

The HC-2250 is a completely self-contained dehumidifier with an active Titanium Silica Gel desiccant wheel. The system is integrally designed and controlled for superior performance in even the highest humidity load conditions.

- Reactivation utility: electric with solid-state proportioning control. Optional: Direct fired gas with modulating gas valve for natural or propane gas
- Dehumidifier housing: process and reactivation air flow insulation. Quiet operation with plenum mounted process fan.



### Features

- Process air: flow rates of 1125 to 3000 SCFM. Nominal moisture removal: 60 lb/hr at 75°F, 50% RH at 2250 SCFM. Delivered air moisture levels of -55°F dew point and lower are attainable
- Contact air seals: separate process and reactivation air pressures up to 8" water gauge with five-year life expectancy
- Process and reactivation fans: centrifugal, direct drive with totally enclosed fan-cooled motors
- Electrical controls: continuous automatic operation including motor starters, overload protective devices and full controls with indicating lights and fault circuits
- Desiccant reactivation via modulating electric, with propane or natural gas optional
- All wiring to NEC codes
- Drive system: simple drive-belt arrangement with few moving parts.

### Benefits

- Weather-tight construction for indoor or outdoor use
- Low profile cassette design provides space savings
- Quick access for easy maintenance
- Modulating electric, gas: natural or propane
- Cost savings - 18" deep Titanium Silica Gel desiccant provides optimal drying performance with the least energy consumed
- Lightweight aluminum construction.



# HC-2250 Desiccant Dehumidifier

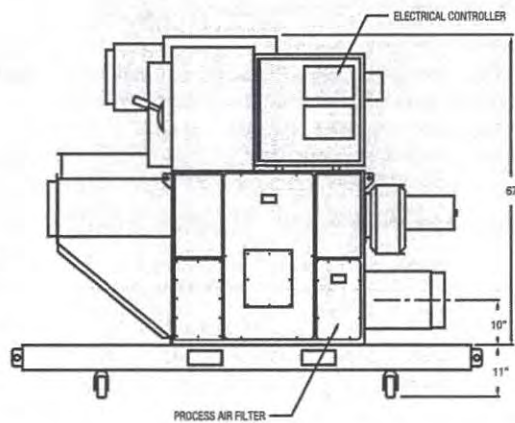
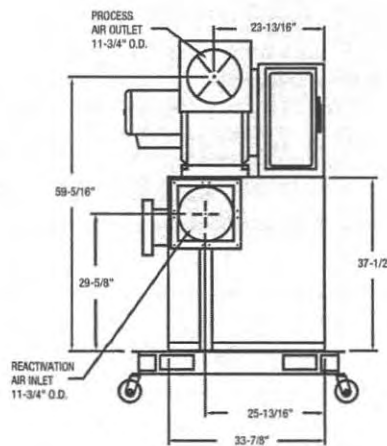
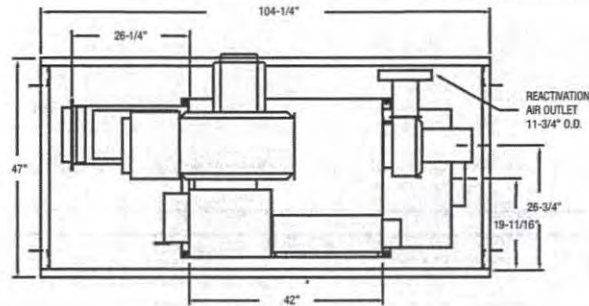

## HC-2250

### Equipment Specifications

- Length: 96"
- Width: 48"
- Height: 84"
- Weight: 1,050 lb
- Full Load Amps (FLA): 55 @ 460 volt three phase-electric reactivation
- Fuel required:
  - 4 g/hr diesel for electric
  - 1.5 g/hr diesel for gas or steam
  - 1-3 therms natural gas/hr
  - 1-3 gal/hr of propane
- Generator requirements:
  - 60 KW-minimum for electric
  - 25 KW-minimum for gas or steam
- SCFM range: 2.5" ESP @ 1125-3000 SCFM
- NFPA 255-ASTM E84 compliant

### HoneyCombe® Wheel Technology

